

# (1) How to program your Admin Fingerprint Lock

**1** Start with lock shackle closed

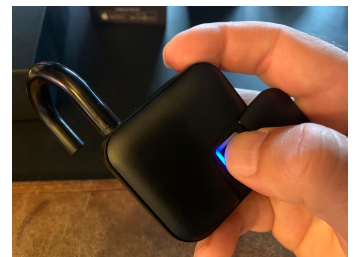

**2** Press gently your finger on the sensor and keep pressing, you will hear a few “Beeps” and it will open the lock, keep pressing until you see a blue light, then release your finger, You will see a green light blinking.



Press gently your finger on the sensor and release, each time you will hear a “Beep” and see either a blue light, or a red light.



**3** You need five (5) blue lights to program the lock, if you get a red light, it means that the lock does not recognize your finger, So keep pressing and releasing...  
...until you get 5 blue lights and hear a long “Beep” and see a stable green light.  
Then you are done. Congrats.

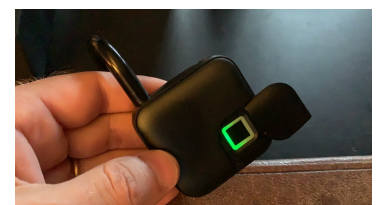
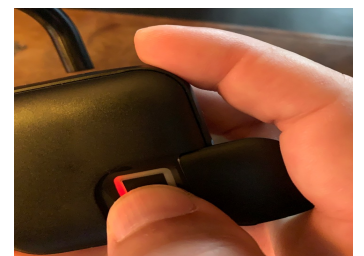

## (2) How to collect the 2<sup>nd</sup> to the 10<sup>th</sup> Fingerprint

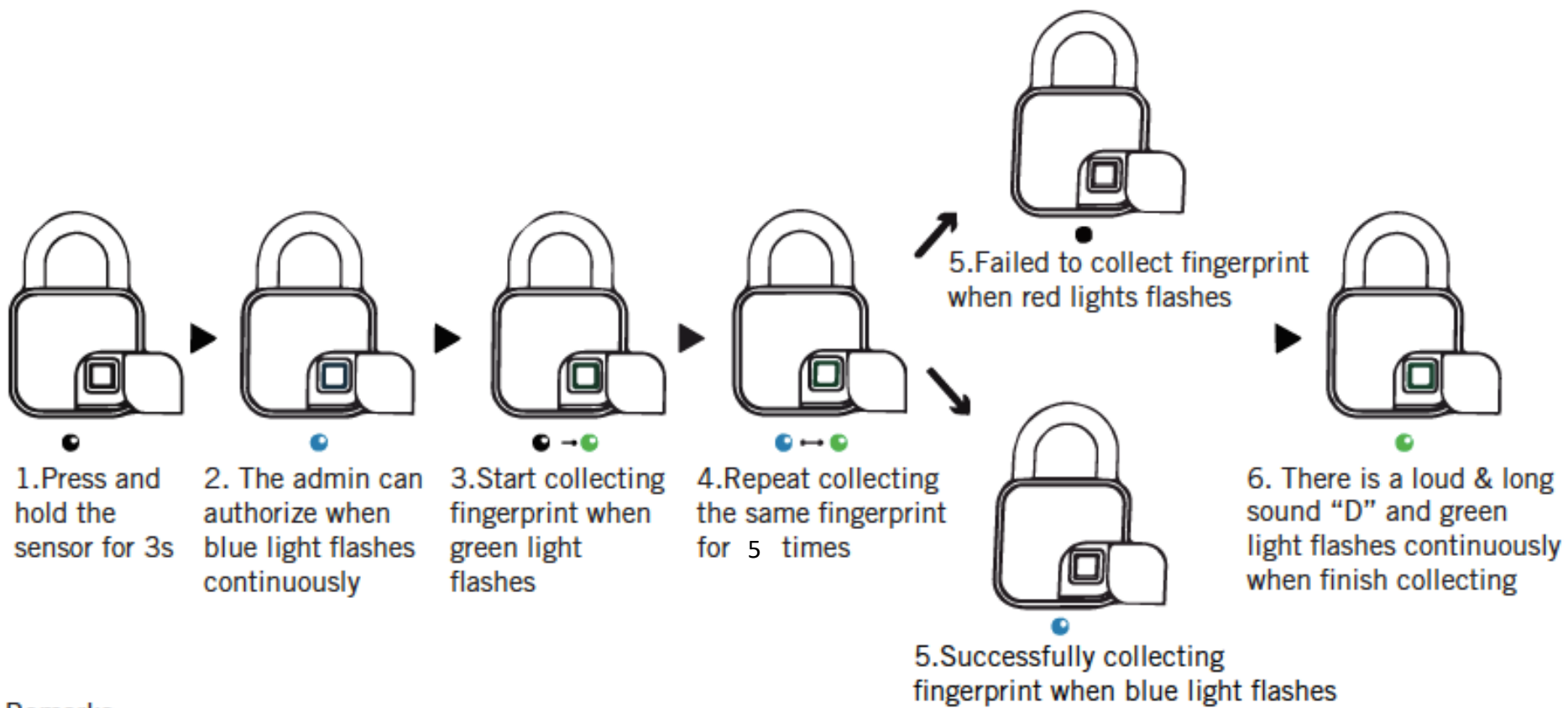

### Remarks

1. The first and second fingerprints are the admins by default
2. One of the admins fingerprint will be needed to authorize when adding fingerprints

## (3) How to delete Fingerprint and reset the lock



1. Press and hold the sensor with your admin Finger for 6s-10s. When the light turns red then release your finger.

2. Use your admin Finger to press the sensor once.

3. The fingerprints are deleted when there is a long sound and the green Light flashes.

Thank you for your purchase.

We hope you will enjoy your new TOKK™ Fingerprint Lock.

If you encounter any issues setting it up and/or using your new product, please do not hesitate to call us and we will be very happy to help you. You can also watch our step-by-step demo video on our website: [www.tokktech.com](http://www.tokktech.com)

Our Customer service email is [contact@predtechnologies.com](mailto:contact@predtechnologies.com)  
Our Customer service phone number is +1 (858) 999-2114 ext 1

**PRED**  
TECHNOLOGIES™